



**TRANSFORMERS AND IGNITORS**

*Your SureFire Ignition Source*

*Engineered solutions for  
power and the environment*

Dongan is pleased to bring over 100 years of transformer design experience to our newest ignition transformer series - the SSI Series Solid State Ignitors. Combining the latest in high tech electronics with good old fashioned workmanship, the SSI Series provides cool operating temperatures, a hot 14kV arc and long life dependability for your fuel oil ignition needs.

From our first UL & CUL Certified ignition transformers in 1922, from the LJH - 90 Multiformer®, to the SSI Series Solid State Ignitors - Dongan is your full spectrum source for oil and gas ignition applications.

Dongan also offers ignition transformers for high ambient and humid environments. Typically these are encapsulated and are designated with an X suffix. We also offer CE approved ignition transformers for the EU.

## Index

Electronic Ignitors - Series SSI.....	3
OEM Replacement Transformers - Series XD.....	4
Universal Replacements	
Electronic - SSI-UR200 .....	5
OEM Transformer - XD-UR200 .....	5
Service Replacement Ignitor Kit - SSI-RK01 .....	5
LJH-90A® and LJH-90C® Multiformer .....	5
Transformer Tester - 1909-82.....	5
Standard Replacement Transformers - Series A10.....	6
10,000 Volts .....	6
12,000 Volts .....	6
Oil and Gas Ignition Transformers.....	7 - 10
5,000 Volts .....	7
6,000 Volts .....	7-8
8,500 Volts .....	8
10,000 Volts .....	8-9
15,000 Volts .....	9
20,000 Volts .....	10
Oil and Gas Electronic Ignitors.....	10
Terminal Accessories.....	10
Industrial Gas & Oil.....	11
Baseplates.....	12
Cross Reference.....	13-15
Warranty .....	13

Primary 120V, Secondary 14,000 V Peak, 35 mA, 50/60 Hz, Mid Point Ground



Dongan Cat. No.	Photo	Burner	Webster	France	Allanson	Sid Harvey	Beckett	Carlin
SSI-UR200	1	Universal Replacement		10SAY-01	2275U			
SSI-AB201	2	ABC Sunray	3-28AB-SR	5LAY-02	2721-631S	T-29-15B		
SSI-WN202	3	Wayne M/MH	3-28AB91	10SAY-03	2275-619	T93E	51825U	41000-SO-WA3
SSI-BK103	4	Beckett A, AF, AFG	3-28AB-BAFR	10SAY-04	2275628G	T92E(1)	5177IU	41000-SO-BK1
SSI-BK204	5	Beckett S	3-28AB-BS	10SAY-05	2275-605	T90E	51824U	41000-SO-BK2
SSI-CR205	6	Carlin 99, 100, 101 CRD	313-28AB85	10SAY-15	2275-630	T94E	51826U	41000-SO-CAS
SSI-CR206	7	Carlin 17.5FR, 200, 201, 500 CRD	313-24AB81	10SAY-16	2275-629	T95E	51840U	41000-S0-SC
SSI-WN208	8	Wayne E	313-28AB78	10SAY-30	2275-620	T88E	51827U	41000-S0-WA2
SSI-WN209	9	Wayne Hi Speed	313-28AB205	10SAY-31	2275-647	T89-10E	51836U	41000-S0-WA1
SSI-CR210	10	Carlin 601	12-8AB7				5188OU	41000-S0-LC
SSI-AR211	11	Aero	3-24AB-AER	10SAY-56	2275-456	T87E	51828U	41000-S0-AR
SSI-DC212	12	Ducane						
SSI-WN216-W	13	Wayne						

# XD Series OEM Replacement Transformers



Primary 120V, Secondary 10,000 V, 22 mA, 60 Hz, Mid Point Ground



Dongan Cat. No.	Photo	Burner	Webster	France	Allanson	Sid Harvey
XD-UR200	1	Universal Replacement			2721	
XD-AB201	2	ABC Sunray	313-25AB86	5LAY-02	2721-631A	
XD-WN202	3	Wayne M/MH	313-28AB91	5LAY-03	2721-619	T93
XD-BK103	4	Beckett A, AF, AFG	3-28AB-BAF	5LAY-04	2721-628	TB-92
XD-BK204	5	Beckett S	3-28AB-BS	5LAY-05	2721-605	T-90
XD-CR205	6	Carlin 99, 100, 101 CRD Mlser	313-28AB85	5LAY-15	2721-630	T-94
XD-CR206	7	Carlin 17.5FR, 200, 201, 500 CRD	313-24AB81	5LAY-16	2721-629	T-95
XD-AB207	8	ABC Sunray	313-25AB59	5LAY-20	2721-411	T-84
XD-WN208	9	Wayne Model E	313-25AB78	5LAY-30	2721-620	T-88
XD-WN209	10	Wayne Blue Angel Eagle One	313-28AB-205W	5LAY-31	2721-647	
XD-AR211	11	Aero	3-24AB-AER	5LAY-56	2721-456	TA-10
XD-DC212	12	Ducane	313-25AB90	5-LAY-15	2721-630	

# Universal Replacement Systems - Tester

Dongan Universal Replacements are available for every service need - Electronic, Electronic Replacement Kits, OEM-Iron Core, and LJH-90A® & LJH-90C® Multiformer. They are engineered to fit the most common applications with base plates and replacement terminals on most of the popular OEMs. Many competitors base plates may be attached as well.



Electronic Replacement Kit



XD-UR200 Universal OEM Iron Core



SSI-UR200 Universal Electronic ignitor

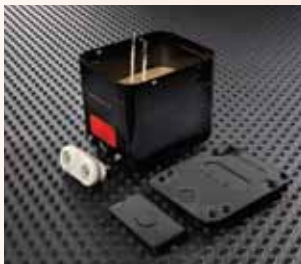

LJH-90A Universal Iron Core



1909-82 Iron Core Transformer Tester

## SSI-RK01 Electronic Replacement Kit

The Dongan Field Service Replacement Kit is a handy way of keeping several universal replacement ignitors and the most common baseplates and replacement terminals for all the most popular OEMs.

### Contents

Ignitors: 2 SSI-UR200 Ignitors

Base Plates: 1 E202WN - Wayne 2 E103BK - Beckett

1 E204BK - Beckett 1 E205CR - Carlin

1 E208WN - Wayne 1 E211AR - Aero

1 Accessory / Terminal Pack

## XD-UR200, Universal OEM - Iron Core Replacement

The XD-UR200 replaces most OEM Iron Core transformers when equipped with the appropriate replacement base and terminals. It is conveniently designed to allow the attachment of many competitors baseplates

## LJH-90A® & LJH-90C® Multiformer Universal Transformer, 10,000 Volt M.P.G.

LJH-90A, 120 Volt Primary

LJH-90C, 240 Volt Primary

(Other voltages available on request)

(Not Suitable for SSI Series)

- Checks Transformers under Actual Operating Conditions
- Checks Mid-Point and End-Ground Transformers
- Checks Line Voltage
- Rugged Steel "Tool Box" Carrying Case
- Analog Input / Output Meter

## H.V. Cable

GT-10 10,000 volt spark cable

GT-15 15,000 volt spark cable

## Primary 120V\*, Secondary 10,000 V, 22 mA, 60 Hz, Mid Point Ground

### A10-SF10

C10-SF10 240 V 60 Hz.  
E10-SF10 110 V 50 Hz  
F10-SF10 220 V 50 Hz

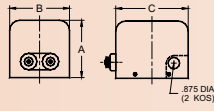

A	B	C
4.31	4.38	5.50

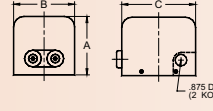

A	B	C
4.31	4.44	5.38

### A10-SJ10

C10-SJ10 240 V 60 Hz.  
E10-SJ10 110 V 50 Hz  
F10-SJ10 220 V 50 Hz

### A10-SQ10

C10-SQ10 240 V 60 Hz.  
E10-SQ10 110 V 50 Hz  
F10-SQ10 220 V 50 Hz

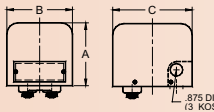

A	B	C
4.25	4.44	5.38

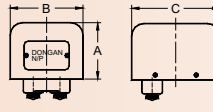

A	B	C
3.44	4.44	5.38

### A10-SQ35

C10-SQ35 240 V 60 Hz.  
E10-SQ35 110 V 50 Hz  
F10-SQ35 220 V 50 Hz

### A10-SR10

C10-SR10 240 V 60 Hz.  
E10-SR10 110 V 50 Hz  
F10-SR10 220 V 50 Hz

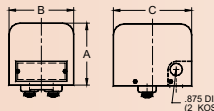

A	B	C
4.25	4.44	5.38

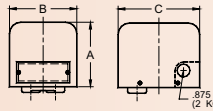

A	B	C
4.25	4.44	5.38

### A10-SV10

C10-SV10 240 V 60 Hz.  
E10-SV10 110 V 50 Hz  
F10-SV10 220 V 50 Hz

### A10-SV35

C10-SV35 240 V 60 Hz.  
E10-SV35 110 V 50 Hz  
F10-SV35 220 V 50 Hz

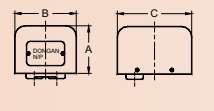

A	B	C
3.44	4.44	5.38

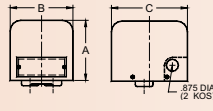

A	B	C
4.25	4.44	5.38

### A10-SW10

### A10-SY10

C10-SY10 240 V 60 Hz.  
E10-SY10 110 V 50 Hz  
F10-SY10 220 V 50 Hz

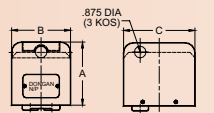

A	B	C
4.75	4.44	5.38

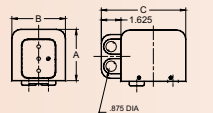

### A10-SP10

### A10-SX10

C10-SX10 240 V 60 Hz.  
E10-SX10 110 V 50 Hz  
F10-SX10 220 V 50 Hz

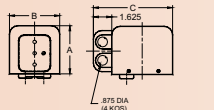

A	B	C
4.25	4.44	7.19

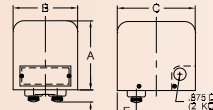

A	B	C	D	E
4.25	4.44	5.38	.38	.88

### A12-SV10

C12-SV10 240 V 60 Hz.

### A10-S32

Lennox

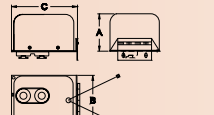

A	B	C
3.44	4.44	5.81

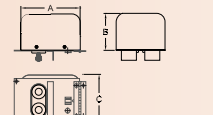

A	B	C
5.31	3.50	4.31

### A10-SK50

Beckett A & AF  
Heavy Duty Replacement

### A10-SV351

Arc Crane

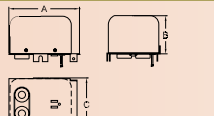

A	B	C
5.31	3.50	4.44

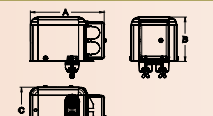

A	B	C
7.19	4.31	4.44

### A10-SP18

Arco

\* Most Standard Replacement Transformers are available in 240V, 60 Hz models as well as 220, 50 Hz and 110V, 50 Hz variations. Contact your Dongan Representative or the factory for additional help.

## Universal - 5,000 Volts

Secondary 5,000 V 20 mA, 115 VA, End Ground		
Catalog No.	Primary	Hz
A05-SA6	120	60
B05-SA6	120	25
C05-SA6	240	60
E05-SA6	110	50
F05-SA6	220	60
K05-SA6	208	60
N05-SA6	480	60

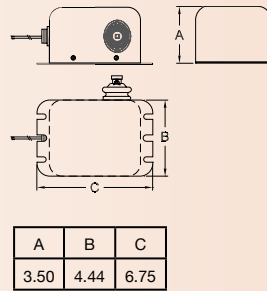

## Universal - 6,000 Volts

Secondary 6,000 V 20 mA, 175 VA, End Ground		
Catalog No.	Primary	Hz
A06-SA6	120	60
C06-SA6	240	60
E06-SA6	110	50
F06-SA6	220	60
N06-SA6	480	60

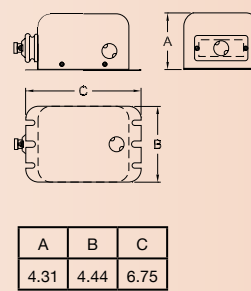

## Weather Resistant

Secondary 5,000 V 20 mA, 115 VA, End Ground		
Catalog No.	Primary	Hz
A05-SC7	120	60

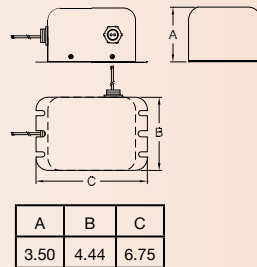

## 6000 Volts, Epoxy Filled

Secondary 6,000 V 20 mA, 175 VA, End Ground		
Catalog No.	Primary	Hz
A06-SA6X	120	60
C06-SA6X	240	60
N06-SA6X	480	60

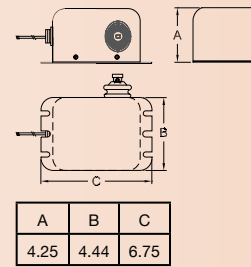

## Power Flame

Secondary 6,000 V 20 mA, 175 VA, End Ground		
Catalog No.	Primary	Hz
A06-SA6PF	120	60

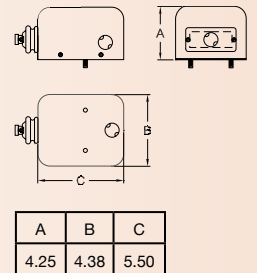

## 6000 Volts, Epoxy Filled CE Marked

Secondary 6,000 V 20 mA, 175 VA, End Ground		
Catalog No.	Primary	Hz
E06-SA6XE	110	50
F06-SA6XE	220	60

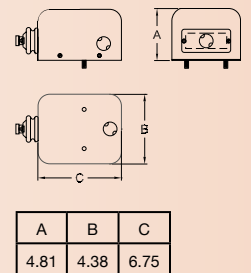

## Fulton Boiler

Secondary 6,000 V 20 mA, 175 VA, End Ground		
Catalog No.	Primary	Hz
A06-SC2	120	60

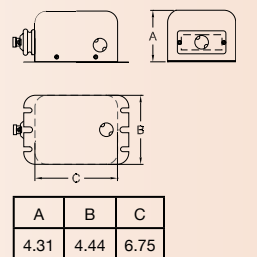

## Gordon Piatt

Secondary 6,000 V 20 mA, 175 VA, End Ground		
Catalog No.	Primary	Hz
A06-SA6GP	120	60

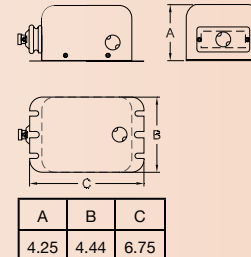

## Ray

Secondary 6,000 V 20 mA, 175 VA, End Ground		
Catalog No.	Primary	Hz
A06-SD7	120	60

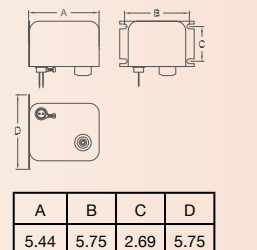

## Petro

Secondary 6,000 V 20 mA, 175 VA, End Ground		
Catalog No.	Primary	Hz
A06-SA21	120	60

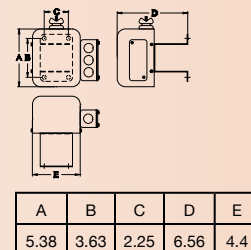

## Cleaver Brooks

Secondary 6,000 V 20 mA, 175 VA, End Ground		
Catalog No.	Primary	Hz
A06-SJ4	120	60

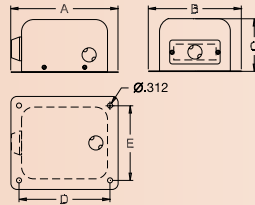

A	B	C	D	E
6.63	5.75	4.81	5.63	4.63

## Cleaver Brooks

Secondary 6,000 V 20 mA, 175 VA, End Ground		
Catalog No.	Primary	Hz
A06-SJ5	120	60

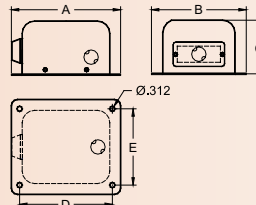

A	B	C	D	E
6.50	5.50	4.75	5.63	4.63

## Gordon Piatt

Secondary 6,000 V 20 mA, 175 VA, End Ground		
Catalog No.	Primary	Hz
A06-SV12	120	60

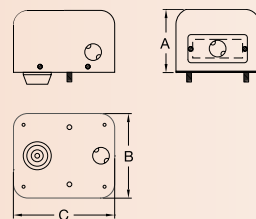
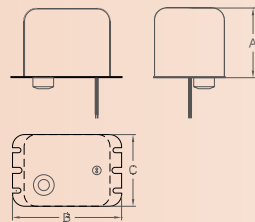

## Dunham Bush

Secondary 6,000 V 20 mA, 175 VA, End Ground		
Catalog No.	Primary	Hz
A06-SY3	120	60

A	B	C
4.25	4.44	5.38

## Universal

Secondary 8,500 V 20 mA, 230 VA, End Ground		
Catalog No.	Primary	Hz
A08-SA1	120	60

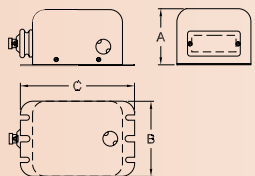

A	B	C
4.31	4.44	6.75

## Industrial Combustion

Secondary 8,500 V 20 mA, 230 VA, End Ground		
Catalog No.	Primary	Hz
A08-SJ5	120	60

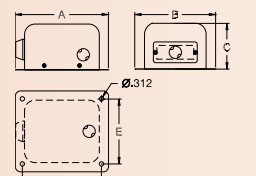

A	B	C	D	E
6.50	5.50	4.75	5.63	4.63

## Universal

Secondary 10,000 V 22 mA, 250 VA, End Ground		
Catalog No.	Primary	Hz
A10-LA2	120	60
C10-LA2	240	60
K10-LA2	208	60
E10-LA2	110	50
F10-LA2	220	50

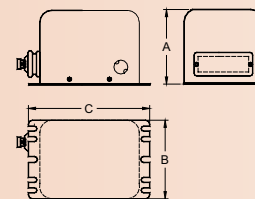

A	B	C
4.69	4.94	7.63

## Universal

Secondary 2 x 5,000 V or 10,000 22 mA, 250 VA		
Catalog No.	Primary	Hz
A10-LF3	120	60
C10-LF3	240	60
N10-LF3	480	60

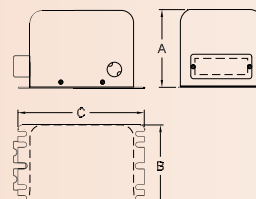

A	B	C
4.69	4.94	7.63



**Secondary 10,000 V  
22 mA, 250 VA, End Ground**

Catalog No.	Primary	Hz
A10-LA2X	120	60
A10-LN2X	120	60
C10-LA2X	240	60
E10-LA2X	110	60
F10-LA2X	220	60
N10-LA2X	480	60

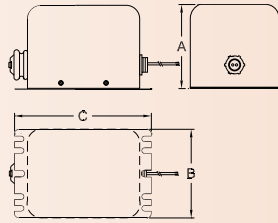

A	B	C
4.69	4.94	7.63

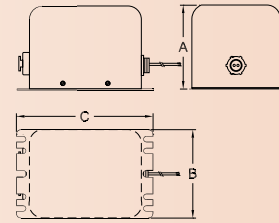

A	B	C
4.69	4.94	7.63

**Universal**

**Secondary 2 x 5,000 V  
or 10,000  
22 mA, 250 VA**

Catalog No.	Primary	Hz
A10-LF3X	120	60
C10-LF3X	240	60
N10-LF3X	480	60

**10,000 V Epoxy Filled**

**10,000 V Epoxy Filled**

**Universal**

**Secondary 10,000 V  
22 mA, 250 VA, End Ground**

Catalog No.	Primary	Hz
A10-LA22	120	60
C10-LA22	240	60
F10-LA22	220	50

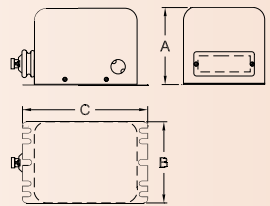

A	B	C
4.69	4.94	7.63

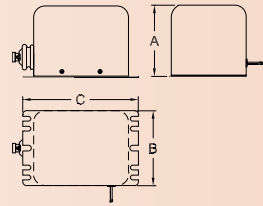

A	B	C
4.69	4.94	7.63

**ABB Combustion  
Engineering**

**Secondary 10,000 V  
22 mA, 250 VA, End Ground**

Catalog No.	Primary	Hz
A10-LC6	120	60

**Protection Controls**

**Secondary 10,000 V  
22 mA, 250 VA, End Ground**

Catalog No.	Primary	Hz
A10-SG6	120	60

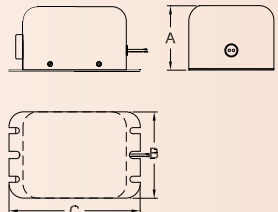

A	B	C
4.81	4.44	6.75

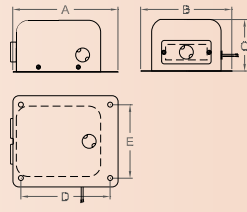

A	B	C
6.50	5.50	4.75

**Industrial Combustion**

**Secondary 10,000 V  
22 mA, 250 VA, End Ground**

Catalog No.	Primary	Hz
A10-SJ5	120	60
C10-SJ5	240	60
F10-SJ5	220	50
E10-SJ5	110	50

**Gordon Piatt**

**Secondary 10,000 V  
22 mA, 250 VA  
Mid Point Ground**

Catalog No.	Primary	Hz
A12-SV22	120	60

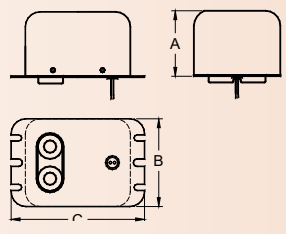

A	B	C
4.75	4.44	6.75

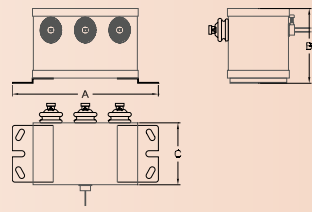

A	B	C
10.63	5.44	5.50

**Universal**

**Secondary 3 x 5,000 V  
22 mA, 375 VA  
End Ground**

Catalog No.	Primary	Hz
A15-LA6	120	60

## Universal

Secondary 2 x 7,500 V 30 mA, 560 VA End Ground		
Catalog No.	Primary	Hz
A15-LA61	120	60

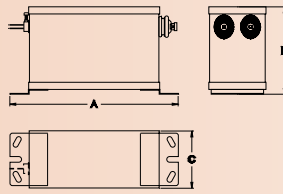

A	B	C
13.32	6.88	4.50

## Universal

Secondary 4 x 5,000 V 22 mA, 500 VA End Ground		
Catalog No.	Primary	Hz
A20-LA7	120	60

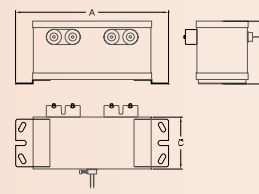

A	B	C
12.58	5.44	4.50

## Solid State Industrial Gas Ignition

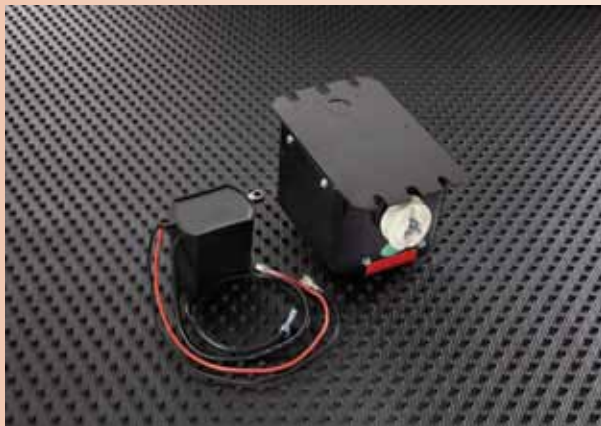

Secondary 6,000 V 35 mA, 250 VA, End Ground - Solid State			
Catalog No.	Manufacturer	Primary	Hz
SSI-URA06	Interchangeable	120	60
SSI-SAA06	As above with base		
SSI-CBA06-SJ4	Cleaver Brooks	120	60
SSI-DBA06	Dunham Bush	120	60
SSI-GPA06	Gordon & Piatt	120	60
SSI-GPA06-SV12	Gordon & Piatt	120	50
SSI-PFA06	Power Flame	120	50

## Terminals & Accessories



### Terminal Accessories

D1406 (1)	D202 (9)
D669 (2)	D638 (10)
TP-125 (3)	TP 52290 (11)
D872 (4)	TP243 (12)
TP118 (5)	D300 (13)
D637 (6)	SIT-212 (14)
H1032 (7)	SIT-212A (15)
	D1032 (8)

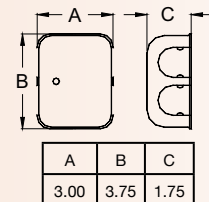

X101 Junction Box (16)

A	B	C
3.00	3.75	1.75

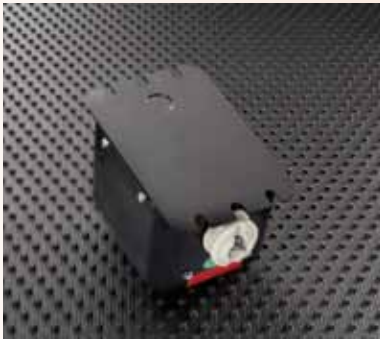

A06-SA6

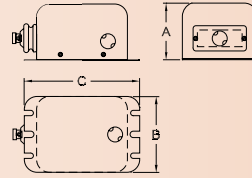

A	B	C
4.31	4.44	6.75

### Universal - 6,000 Volts

**Secondary 6,000 V**  
20 mA, 175 VA, End Ground

Catalog No.	Primary	Hz
A06-SA6	120	60
C06-SA6	240	60
E06-SA6	110	50
F06-SA6	220	60
N06-SA6	480	60

### Universal

Secondary 10,000 V		
22 mA, 250 VA, End Ground		
Catalog No.	Primary	Hz
A10-LA2	120	60
C10-LA2	240	60
K10-LA2	208	60
E10-LA2	110	50
F10-LA2	220	50

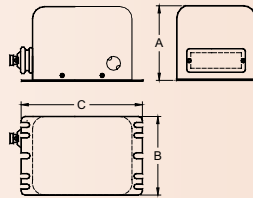

A	B	C
4.69	4.94	7.63

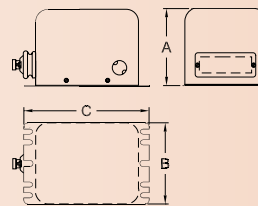

A	B	C
4.69	1.94	7.63

### Universal

Secondary 10,000 V		
22 mA, 250 VA, End Ground		
Catalog No.	Primary	Hz
A10-LA22	120	60
C10-LA22	240	60
F10-LA22	220	50

### ABB Combustion Engineering

Secondary 10,000 V		
22 mA, 250 VA, End Ground		
Catalog No.	Primary	Hz
A10-LC6	120	60

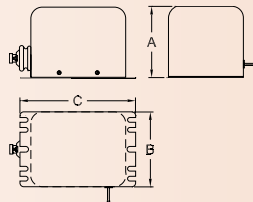

A	B	C
4.69	4.94	7.63

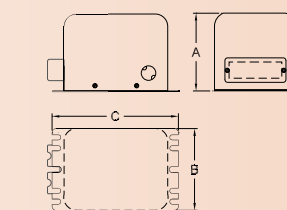

A	B	C
4.69	4.94	7.63

### Universal

Secondary 2 x 5,000 V or 10,000 22 mA, 250 VA		
Catalog No.	Primary	Hz
A10-LF3	120	60
C10-LF3	240	60
N10-LF3	480	60

## Replacement Bases for LJH-90A® & Standard Replacement Transformers

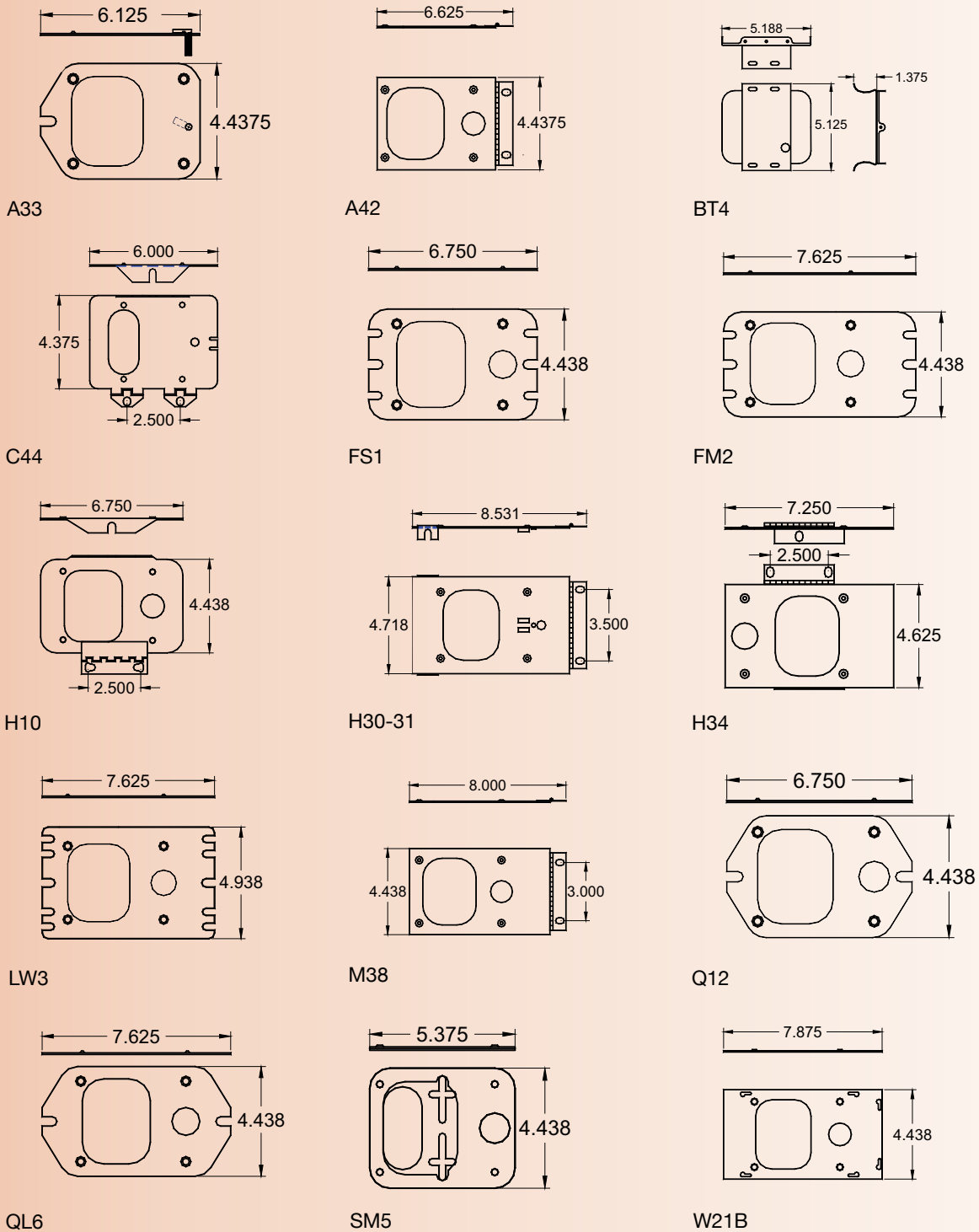

Additional base plates are available. Please contact Dongan Customer Service or your Dongan Representative for additional information.

## Warranty & Cross Reference Data

Dongan Electric Manufacturing Company (Dongan), at Dongan's option, warrants to the original purchaser to correct by repair, refund of the original purchase price, or replacement, ignition transformers/igniters that fail within a three year warranty period.

Said warranty applies from the date of manufacture, provided the product has been installed, operated and maintained in accordance with all accepted industry practices and standards, that conditions of operation have been normal at all times, and that the product has not been subjected to any undue stress from excess voltage, frequency, load, or insufficient or inadequate ventilation.

Prompt written notice of any defect must be submitted to Dongan within the warranty period as provided above. The warranty applies on condition that Dongan's examination determines that the warranty claim is valid as submitted by the original purchaser.

Dongan's obligation under this warranty is in lieu of all other warranties expressed or implied including any warranties of merchantability and fitness for purpose and is limited to a refund of the original purchase price, replacement, or repair of the defective product.

Dongan will not be liable for any incidental, consequential, contingent or special damages, including loss of use, function or profits arising out of or in connection with the use of Dongan's products, and shall have no other liability for payment of any other damages. The remedy provided herein is Dongan's entire liability and the purchaser's sole remedy.

### Cross Reference Data

Dongan	France	Allanson	Sid Harvey	Webster	Thermolok
LJH-90A Universal 6-Way	LAUV	421BT636	T1-15	312-25AX0600	T-628
LJH-90A Universal 5-Way		421BT384		312-25AX0500	
A10-SF10	LFAV	421BT387	T-21N	312-24A0202	
A10-SJ10	LFBV	421BT299	T-21M	312-25A0202	
A10-SP10					
A10-SQ10	LGDV	421BT290	T-17N	312-24AB0202	C-554
A10-SQ35					
A10-SR10	LGCV	421BT104	T-31N	312-24AB0237	
A10-SV10	LGFV	421BT332	T-17M	312-25AB0202	C-555
A10-SV35					
A10-SW10	LGEV	421BT276	T-17FM	312-25AB0237	C-551
A10-SY10		421BT066			
A10-SX10	LGDW	421BT240	T-18N	312-24ABE202	C-456
A12-SV10					

# Cross Reference Data

Dongan	Burner	Pri.	Sec.	H <sub>z</sub> .	mA	France	Allanson	Sid Harvey	Webster
A05-SA6		120	5,000	60	20				
A05-SC7	Aeroil	120	5,000	60	20				
A06-SA6		120	6,000	60	20	6EEGW-2	1092-S	T-246N	
A06-SA6G	3 Wire for Canada	120	6,000	60	20		1092-SG		612-6A020/612-6A072
A06-SA6GP	Gordon Piatt	120	6,000	60	20		1092-S		
A06-SA6PF	Power Flame	120	6,000	60	20		1092-PF		612-6A056
A06-SA6X		120	6,000	60	20				
A06-SA21	Petro	120	6,000	60	20	6EEGW-1	1092-7	T-146N	612-6A063
A06-SB6		120	6,000	60	20	6EEGW-2	1092-F		612-6A7
A06-SD7	Ray Burner	120	6,000	60	20	3RAFYR-14	1092-N	T-193N	613-6A10
A06-SI1	North American	120	6,000	60	20		1092-NA		612-8A02
A06-SJ5	Cleaver Brooks Industrial Comb.	120	6,000	60	20		1092-H		612-8A021
A06-SW3		120	6,000	60	20				612-8AB051
A06-SY3	Iron Fireman Dunham Bush	120	6,000	60	20		1092-K		612-8AB017
A08-SA1		120	8,500	60	20	85EY-2			812-6A010
A08-SJ5	Industrial Comb.	120	8,500	60	20				812-8A012
A08-SW3		120	8,500	60	20				812-8AB012
A10-LA2		120	10,000	60	22				
A10-LA22		120	10,000	60	22		542-A, 542-GP		312-6A0456
A10-LC6	Comb. Engineering	120	10,000	60	22				
A10-LF3		120	2 x 5,000 10,000	60	22				
A10-LN2X							542-C		
A10-SF10	Fulton Boiler	120	10,000	60		LFAV	421-BT387	T-21N	312-24AB0202
	Cleaver Brooks	120	10,000	60					312-8A0169V
A10-SW3	Industrial Comb.	120	10,000	60	22				312-25AB0420
A15-LA61		120	2 x 7,500	60	30				1412-A6
C06-SA6X		240	6,000	60	20				612-6F020
C06-SJ5	Industrial Comb.	240	6,000	60	20				612-8F038 V
C10-SJ5	Industrial Comb.	240	6,000	60	23				312-8F097
C10-SW3	Industrial Comb.	240	6,000	60	23				312-25FB0420
E06-SA6		110	6,000	50	20				612-6B020
E10-SJ5	Industrial Comb.	110	10,000	50	22				312-8B0109V
F06-SA6		220	6,000	50	20				612-6L020
F06-SJ5	Industrial Comb.	220	6,000	50	20				612-8L021
A12-SV10	Beckett	120	12,000			2KACVS-2	2714-633	T-12	12-8AB7

## Cross Reference Data

Burner / Application	Dongan	Base & Terminals	France	Allanson	Sid Harvey	Webster	Thermolok
ABC	XD-AB207		5LAY-20	2721-411	T-84	313-25AB59	C-792
ABC/Sunray	XD-AB201		5LAY-12	2721-631A	T-29-15B	s/b 312-25AB86	TSR-10
ABC Crane	A10-SV351		LKR-2	2721-409	T-86	313-25AB73	C-793
ABC D & LC	A10-SQ35	Use Orig. Base + Term	5-LAY-11	2721-452	T-34-B	3-25AB65	
Acme / Quiet Heet	A10-SR12		LGNV	521-104	T-31-N	312-24AB084	C-53
Aero	XD-AR211		5LAY-56	2721-456	T-87	3-24AB-AER	TA-10
Arco / American Standard	A10-SP18		LGHW	421-557	T-183B	312-26ABE23	C-483
Armstrong / Esso	A10-SX10	Q12	LGPW-2	421-340	T-80-3M	312-25ABE1	
Barriere	A10-SQ10	D669 + Orig. Base		421-254A			
Beckett A, AF, AFG	XD-BK103		5LAY-04	2721-628	T-92	3-28AB-BAF	TB-10
Beckett S	XD-BK204		5LAY-05	2721-605	T-90	3-28AB-BS/3-28AB92	TB-11
Brock	XD-UR200	Use Orig. Base & Term	5LAY-57	2721-627			
Carlin 99,100,CRD	XD-CR205		5LAY-15	2721-630	T-94	313-28AB85	TC-10
Carlin 200, 201, 500 CRD	XD-CR206		5LAY-16	2721-629	T-95	313-24AB81	TC-11
Carlin	A12-SV10	Use Orig. Base & Term	2KACVS-2	2714-633	T-12	12-8AB7	
Cleaver Brooks	A10-SJ5			421-659		312-8A097/312-8A0169	
Cleaver Brooks	A12-SJ10		2KAAVS-1	2714-359		12-8A08	
Conroy	A10-SQ35	D6638+ Orig. Base		421-558			
Delco P-200	A10-SQ182		LKP	2721-222A	T24N	313-24AB68	
Ducane	XD-DC212		5LAY-06	421-430		313-25AB90	
Gordon Piatt	A10-SV22			421-661		313-25AB100	
Gordon Piatt	A12-SV10	FS1		2714-662		12-8AB02	
Grimsby	A10-SQ35	D638 + Orig. Base		2721-589			
Industrial Combustion	A10-SJ5			421-660		312-8A0169	
John Wood	A10-SQ35	D638 + Orig. Base		2275-069			
Lennox	A10-S32			421-331	T-265	313-25AB62	C-823
Metro	A10-SQ35	D669 + Orig. Base		2275U-368M			
Nu-Way (Large Base)	A10-SQ35	M38 + D300		2721-448	T-120	313-24AB80	C-794
Nu-Way (Small Base)	A10-SQ35	H47 + D300		2721-572	T-122	313-24AB82	C-807
Power Flame	A10-SV10PF			421-655		312-25AB0418	
Power Flame	A12-SV10	SM5		2714-655			
Sunray	A10-SR10	Q12 +D1035+D872		421-104E	T-29-10B	312-26AB022	C-733
Wayne	A10-SV35	Use Orig. Base	5LAY-21	2721-637	T-50	313-25AB49	
Wayne Blue Angel	XD-WN209		5LAY-31	2721-668	T89-10	313-28AB205W/313-28ABWHS	
Wayne E	XD-WN208		5LAY-30	2721-620	T-88	313-25AB78	C-799
Wayne Hi-Speed M, MH	XD-WN202		5LAY-03	2721-619	T-93	313-28AB91	TW-10
York Shipley	A10-SX24		LGEW-1	421-095	T-25B	312-26ABE407	C-510

# Transformers and Custom Magnetics

## Factory and Local Warehouse

### Stocks for:

- Industrial Control Transformers
- General Purpose Transformers
  - Single Phase
  - Three Phase
- Motor Drive Isolation Transformers
- Control Transformers
- K - Factor Transformers
- High Voltage Ignition
  - Gas Ignition
  - Oil Ignition
  - Solid State
- Transformer Lighting Disconnects
- Signaling
- Hospital Isolation
- Epoxy Encapsulated
- CE Marked Transformers
- Constant Voltage
- Auto Transformers
- High Voltage Transformers
- Solar and Wind Energy Transformers
- TP1 DOE Energy Efficient Transformers

## Custom Designs Available:

- Domestic & Export Voltages
- Custom Colors
- Special Frequencies
- Custom Enclosures
- Match Current or Custom Dimensions
- Core & Coil Units
- CE Marked Transformers
- Chokes
- Reactors
- Comprehensive Family Approvals for

